

SUN VALLEY EAST PHASE I

SUN VALLEY P.U.D.
 A PLAT OF A PORTION OF SECTION 23, TOWNSHIP 45 SOUTH, RANGE 42 EAST, INCLUDING A REPLAT OF A PORTION OF BOYNTON GARDENS (6-32)
 PALM BEACH COUNTY, FLORIDA

WINNINGHAM & LIVELY, INC. SURVEYORS - ENGINEERS FORT LAUDERDALE, FLORIDA

SCALE: 1"=100'

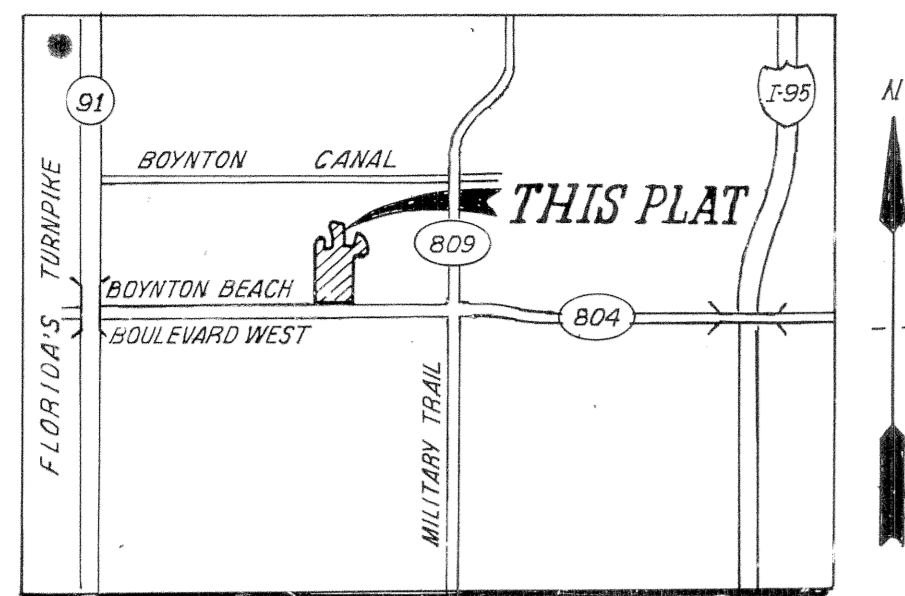
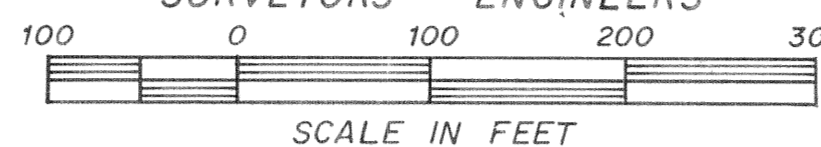

VICINITY MAP
NOT TO SCALE

